



TOWN OF HOPKINTON
DEPARTMENT OF PUBLIC WORKS
PO Box 209
66 Fruit Street
Hopkinton, Massachusetts 01748
508-497-9740
Fax 508-497-9761

January 31, 2013

Kenneth Weismantel, Chairman
Hopkinton Planning Board
18 Main Street
Hopkinton, MA 01748

Re: Scenic Road Public Hearing Request

Dear Mr. Weismantel and Planning Board Members:

I submit the attached Application for a Scenic Road Public Hearing for the removal of trees on scenic roads which are associated with the installation of the new traffic signal at the intersection of West Main and School Streets.

The attached plan shows the location of the trees which must be removed. There are approximately 35 trees as listed below:

Number on Plan	Diameter & Species
1	24" White Oak
2	36" Red Oak
3	16" Red Oak
4	32" White Pine
5	48" Oak
6	Cluster of approximately 30 trees, less than 8" diameter, Invasive Norway Maple, Black Cherry, and Sassafrass

The removal of these trees is necessary to accommodate the proposed construction and to improve the safety of the intersection.

I look forward to the Planning Board's public hearing on this matter where I will present this application.

Sincerely,

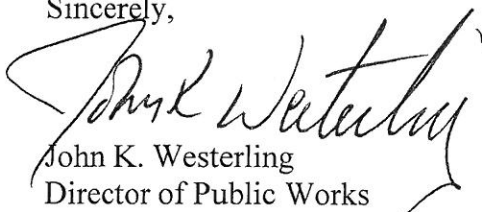

John K. Westerling
Director of Public Works

Attachments



TOWN OF HOPKINTON

OFFICE OF THE PLANNING BOARD

TOWN HALL
18 MAIN STREET
HOPKINTON, MASS. 01748
(508) 497-9755

APPLICATION FOR A SCENIC ROAD PUBLIC HEARING
Ch. 160 of the Bylaws of the Town of Hopkinton, Scenic Roads

Date: 1/29/13

Applicant: TOWN OF HOPKINTON

Address: 18 MAIN ST, HOPKINTON, MA 01748

Daytime Telephone: 508-497-9740 Email: JAMESERLWE@HOPKINTONMA.GOV

Address of Proposed Work: WEST MAIN & SCHOOL STREET INTERSECTION

Assessors Map: _____ Block: _____ Lot: _____

Describe the proposed work, including the species and diameter of each tree to be removed and linear feet of stone wall to be removed/altered: _____

① 24" WHITE OAK

② 36" RED OAK

③ 16" RED OAK

④ 32" WHITE PINE

⑤ 48" OAK

⑥ APPROX. 30 TREES LESS THAN 8" INVASIVE NORWAY MAPLE, BLACK CHERRY,

Is a public hearing required under the provisions of the Public Shade Tree Law or Ch. 186, § 2A?
Trees? Yes: No: SASSAFRASS

If yes, has the Tree Warden been notified: YES

Has a hearing date been set? _____

Submission Requirements Checklist:

- Plan (See Ch. 160)
- Certified list of abutters within 100 feet of the proposed work, from Assessors Office
- _____ \$50.00 filing fee

For Planning Department Use:

Submission Date: _____ Date of Legal Ads: _____

Date of Public Hearing Deadline: _____ Decision Due: _____

Public Hearing Date: _____ Decision Date: _____

DATE	2/7/2012
SCALE	1"=20'
DRAWN BY	JRC
CHECK BY	JRC
SHEET NO.	7 OF XX

Checked & Approved
Invasive Norway Maple, Black Cherry, & Sassafras
 (6)

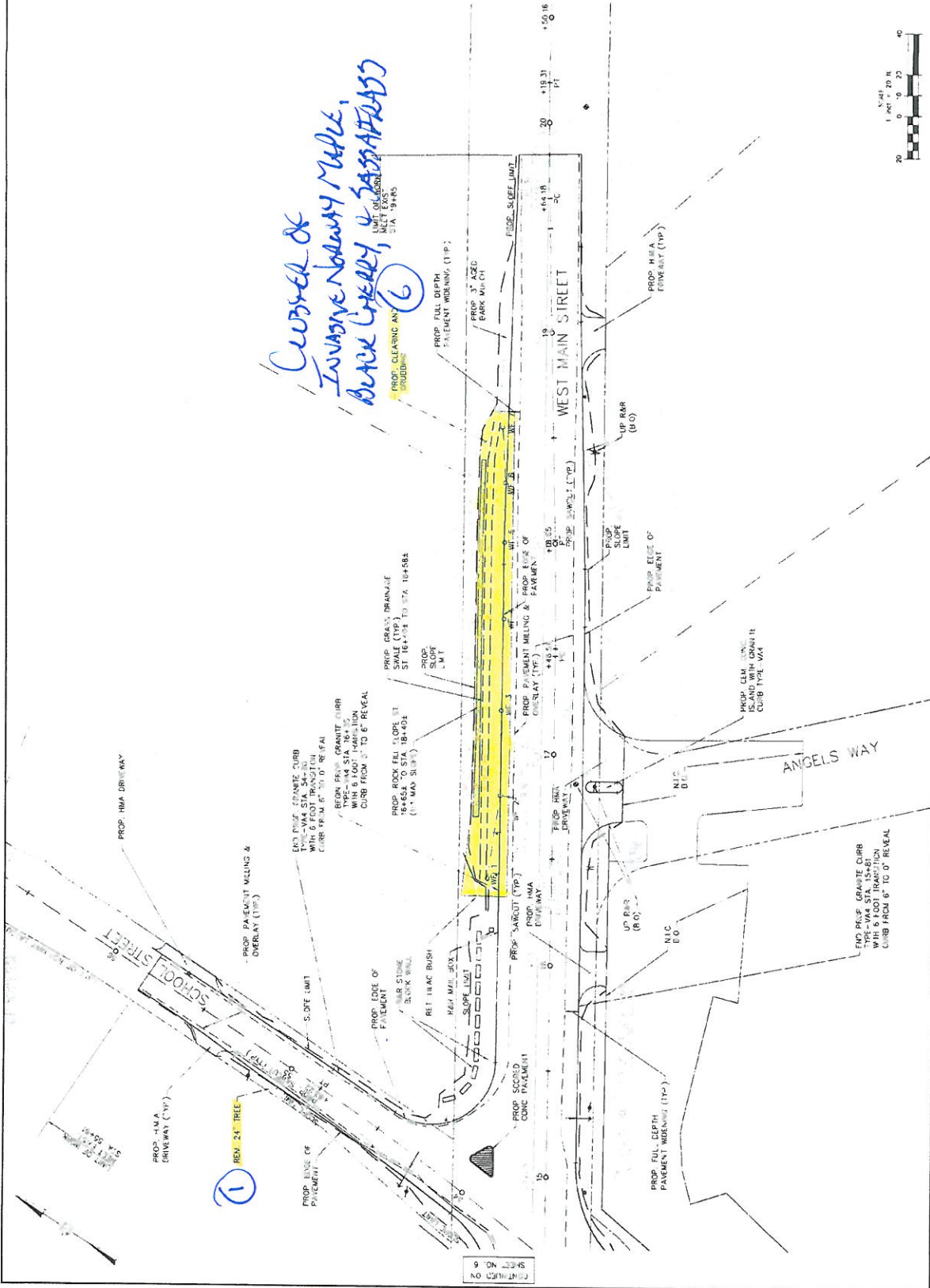

PRINTED ON SHEET NO. 8

